



# Aurora

MODERN FAN COMPANY  
Customer Service  
M-F 8am - 4pm (PST)

(ph) 888.588.3267  
www.modernfan.com

## **Aurora Fan-** Installation instructions

Should you have any questions or difficulty installing your new fan, please contact Modern Fan Co. customer service immediately.

**Note:** Power supply must be turned off prior to any contact with electrical wires. It is recommended that a licensed electrician be hired to install your ceiling fan.

(1) Remove and identify contents of carton.

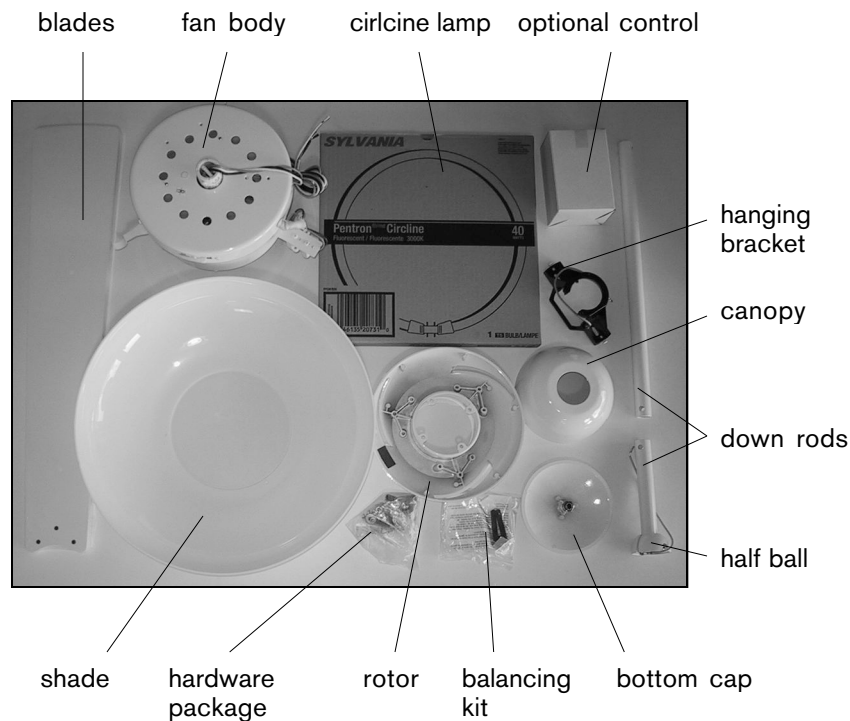

(2) Using the existing screws from your junction box, or the machine screws from the hardware package, secure the hanging bracket to the ceiling junction box.

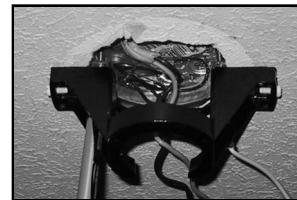

(3) Remove the stopper screw and loosen the set screws on the fan collar. Set the stopper screw aside for step (5).

set screw  
stopper screw

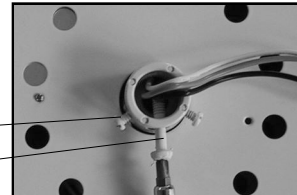

---

**(4)** Remove stopper pin and half ball from small down rod by loosening set screw on half ball. Set all parts aside for steps **(5)** and **(7)**.

stopper pin  
set screw

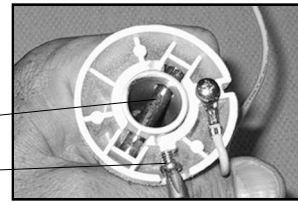

---

**(5)** Run fan wires through selected down rod. Reinstall stopper screw from step **(3)** and firmly tighten set screws on fan collar against down rod.

**Note:** If ceiling height allows, using a longer down rod will increase airflow and efficiency.

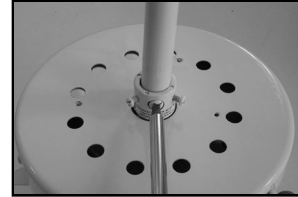

---

**(6)** Slide fan canopy over down rod and carefully rest on top of fan body.



---

**(7)** Reinstall half ball on end of down rod. Be sure that stopper pin is inserted through down rod and seated in half ball. Tighten set screw against down rod.

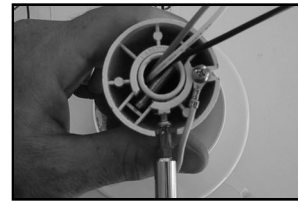

---

**(8)** Lift fan to ceiling and set half ball in the hanging bracket so that the ridge on the edge of the hanging bracket is seated in the slotted channel in the half ball.

With fan safely suspended by bracket, make wire connections with wire nuts included in hardware package as described in the control installation instructions. If using the optional #003 or #004 control, the receiving unit should be placed inside the arms of the hanging bracket and connected now.



---

**(9)** Loosen set screws on the sides of the hanging bracket. Lift canopy to ceiling. With slots on side of canopy aligned with set screws on hanging bracket, tighten set screws to hold canopy in place.

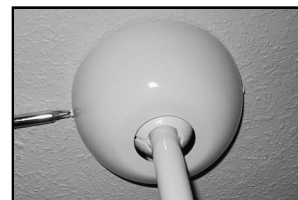

---

**(10)** Carefully insert the lamp into the socket and the two lamp holders. The brass pins on the lamp snap into the socket.

socket  
holder

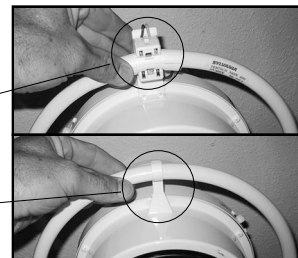

---

**(11)** Remove the three white shade screws from the outer edge of the fan housing. Then use the same three screws to attach the shade to the fan body.  
**Caution:** Do not over tighten. Over tightening may cause the acrylic shade to crack.

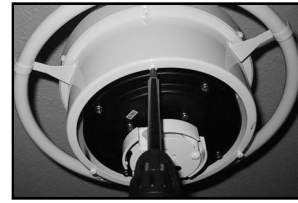

---

**(12)** After attaching the shade as described in step **(11)**, remove the four rotor screws from the fan motor. Keep these screws for step **(14)**.

reinstalled shade screw  
remove rotor screws



---

**(13)** Carefully insert blades into rotor slots, and using pan head screws from hardware package, secure blades to rotor.

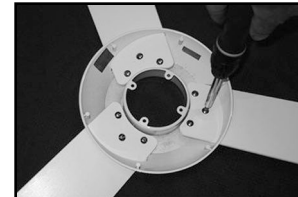

---

**(14)** Install rotor using the four rotor screws from step **(12)**. Be sure screw tabs on rotor are properly aligned with correct holes on motor.



---

**(15)** Attach bottom cap by rotating on in the clock wise direction.



---

**(16)** Your fan is reversible for summer and winter operation. The reverse switch is located on the side of the fan body, above the shade and lamp assembly. The LEFT position is for summer and the RIGHT position is for winter.

---

**(17)** Install wall switch as described in the control installation instructions.

**NOTE:** The Aurora uses a fluorescent lamp and is not compatible with dimmers or dimming switches of any kind. Only on/off switching can be used for the lighting component of this fan.

---

**(18)** The rotor and motor of your fan have been dynamically balanced at the factory. In addition, the blades have been matched to the nearest gram to ensure a well balanced ceiling fan. Furthermore, a blade balancing kit has been included with your fan. Please refer to the instructions packaged with the balancing kit should your fan require additional balancing.

---